



**PVC WATERSTOP**

Since its establishment in 1987, we have served customers around the world for 30 years. We have an experienced R&D technical team and a highly productive management department. We continue to innovate products, optimize manufacturing processes and quality control as our purpose to make our products meet customer requirements. In addition, it can be closer to everyone's living environment and bring consumers a convenient and comfortable environment. Environmental protection and sustainable development are the primary direction of an enterprise.

Upholding the goal of being environmentally friendly, all management operations are directed towards the goals of preventing pollution, reducing waste, and saving resources. Since its establishment, it has continued to develop and innovate, trying to meet the real needs of customers with better services, more advanced manufacturing processes, better quality, and more environmentally friendly materials in the industry.

## PVC WaterStop

Currently, the standing models are A1, A2, A3, B1, B2, B3, E1, E2, and are under continuous development.

The actual specifications can be manufactured separately according to the needs of the project.

# Specifications

Unit:mm

## A TYPE

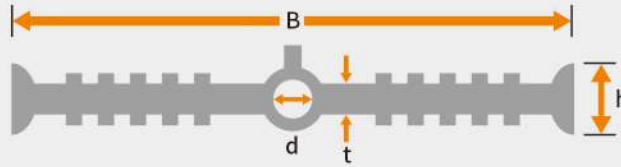

Item.	Spec.	Width (B)	Thickness (t)	h	d	Key no.	Weight kg/m
WS-A1	150 X 4	150 ± 4.5	4.0 ± 0.5	10	10±2	4 or more	1.0
WS-A2	150 X 9	150 ± 4.0	9.0 ± 0.9	16	10±2	8 or more	2.20
WS-A3	220 X 9	220 ± 5.0	9.0 ± 0.9	16	18±2	10 or more	3.05
WS-A4	225 X 4	225 ± 6.5	4.0 ± 0.5	10	10±2	10 or more	1.4
WS-A5	320 X 7	320 ± 9.5	7.0 ± 0.7	14	12±2	8 or more	4.05
WS-A6	400 X 8	400 ± 12.0	8.0 ± 0.8	18	18±2	10 or more	5.0
WS-A7	240 X 5	240 ± 7.0	5.0 ± 0.5	12	10±2	10 or more	1.76
WS-A8	230 X 7.5	230	7.5	12	18±2	10 or more	2.85
WS-A9	150 X 7.5	150	7.5	12	12±2	10 or more	2.0

Existing models

Existing models

Existing models

## B TYPE

WS-B-1

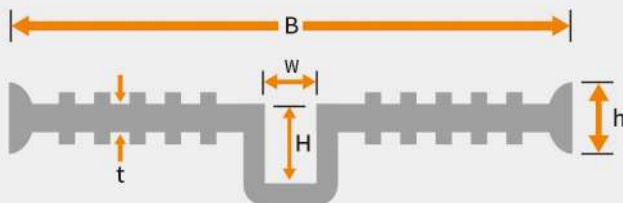

WS-B2.B3

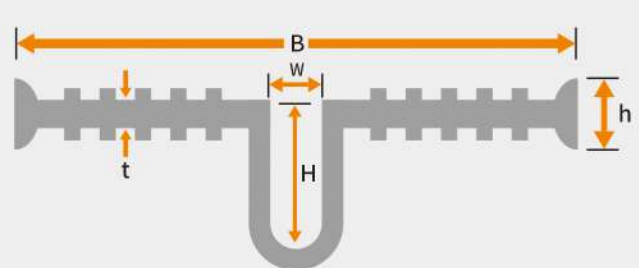

Item.	Spec.	Width (B)	Thickness (t)	Reference		h	Key no.	Weight kg/m
				W	H			
WS-B1	225 X 4	225 ± 6.5	4.0 ± 0.5	18	20	10 or more	10 or more	1.45
WS-B2	230 X 7.5	230 ± 7.5	7.5 ± 0.7	20	52	22 or more	10 or more	3.60
WS-B3	125 X 5	125 ± 4.0	5.0 ± 0.5	20	40	20 or more	6 or more	1.59

Existing models

Existing models

Existing models

# C

## C TYPE

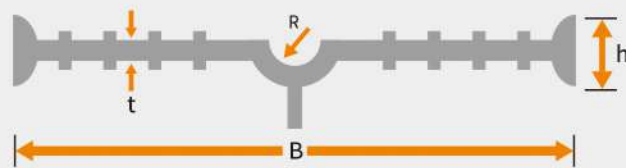

Item.	Spec.	Width (B)	Thickness (t)	Reference (R)	h	Key no.	Weight kg/m
WS-C1	220 X 4	220 ± 6.5	4.0 ± 0.5	10	10 or more	8 or more	1.40
WS-C2	250 X 6	250 ± 7.5	6.0 ± 0.6	10	14 or more	8 or more	2.40
WS-C3	290 X 6	290 ± 8.5	6.0 ± 0.6	12	14 or more	8 or more	2.90



For other types of requirements, we can discuss and cooperate with manufacturing.

# E

## E TYPE

WS-E1.E2

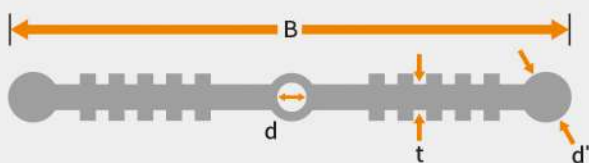

WS-E3.E4.E5

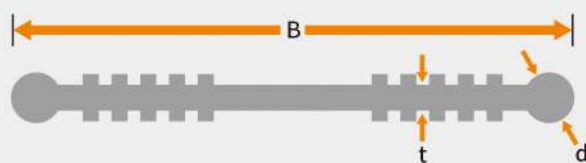

Item.	Spec.	Width (B)	Thickness (t)	d	d'	Key no.	Weight kg/m
WS-E1	150 X 9	150 ± 4.0	9.0 ± 0.9	19 ± 2.0	16 or more	6	2.45
WS-E2	230 X 9	230 ± 7.0	9.0 ± 0.9	12 ± 2.0	16 or more	10	3.35
WS-E3	150 X 9	150 ± 4.0	9.0 ± 0.9	-	16 or more	6	2.13
WS-E4	230 X 9	230 ± 7.0	9.0 ± 0.9	-	16 or more	10	3.12
WS-E5	250 X 11	250 ± 7.5	11 ± 1.0	-	16 or more	5	3.85

Existing models

Existing models

## F F TYPE

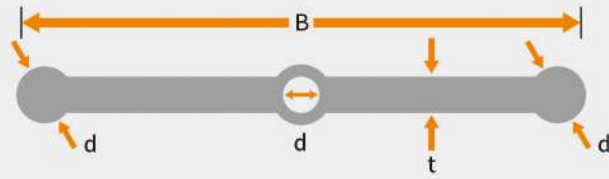

Item.	Spec.	Width (B)	Thickness (t)	d	Weight kg/m
WS-F	152 X 9	152 ± 4.0	9.0 ± 0.9	19 ± 2	2.75

## G G TYPE

WS-G-1

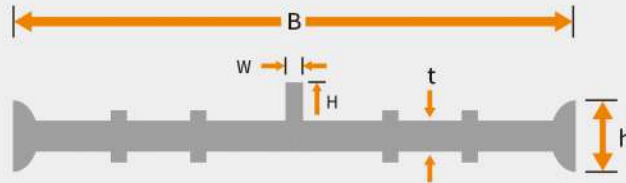

Item.	Spec.	Width (B)	Thickness (t)	Reference		h	Key no.	Weight kg/m
				W	H			
WS-G1	152 X 9	150 ± 4.0	9.0 ± 0.9	3 or more	9 or more	15 or more	4	2.10
WS-G2	200 X 9	200 ± 5.0	9.0 ± 0.9	3 or more	9 or more	15 or more	4	3.00

## J J TYPE

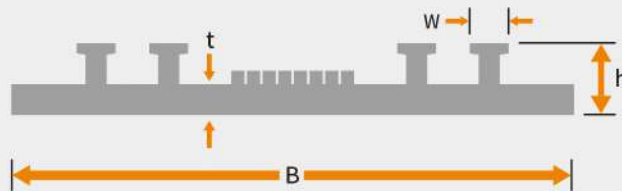

Item.	Spec.	Width (B)	Thickness (t)	Height of key (h)	width of key (w)	Weight kg/m
WS-J1	240 X 5	240 ± 7	5.0 ± 0.5	20 or more	15 or more	2.25
WS-J2	320 X 5	320 ± 20	5.0 ± 0.5	20 or more	15 or more	2.86
WS-J3	350 X 9	350 ± 10	9.0 ± 0.9	48 or more	19 or more	7.2

# K

## K TYPE

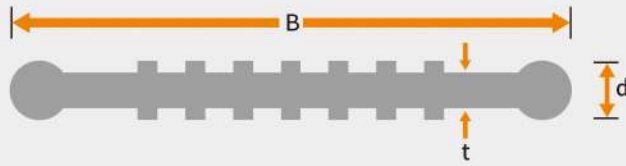

Item.	Spec.	Width (B)	Thickness (t)	d	Weight kg/m
RM-E	165 X 4	165 ± 10	4.0 ± 0.5	12	7以上

# L

## L TYPE

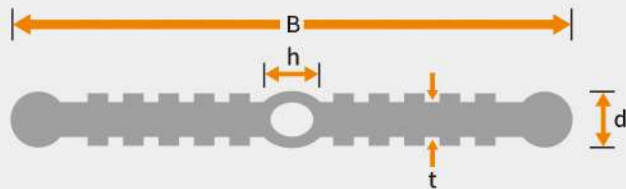

Item.	Spec.	Width (B)	Thickness (t)	w	h	Weight kg/m
RM-L	205 X 4	205 ± 10	4.0 ± 0.5	12	14	10以上

# W

## Welding Rod

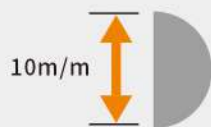

For other types of requirements, we can discuss and cooperate with manufacturing.

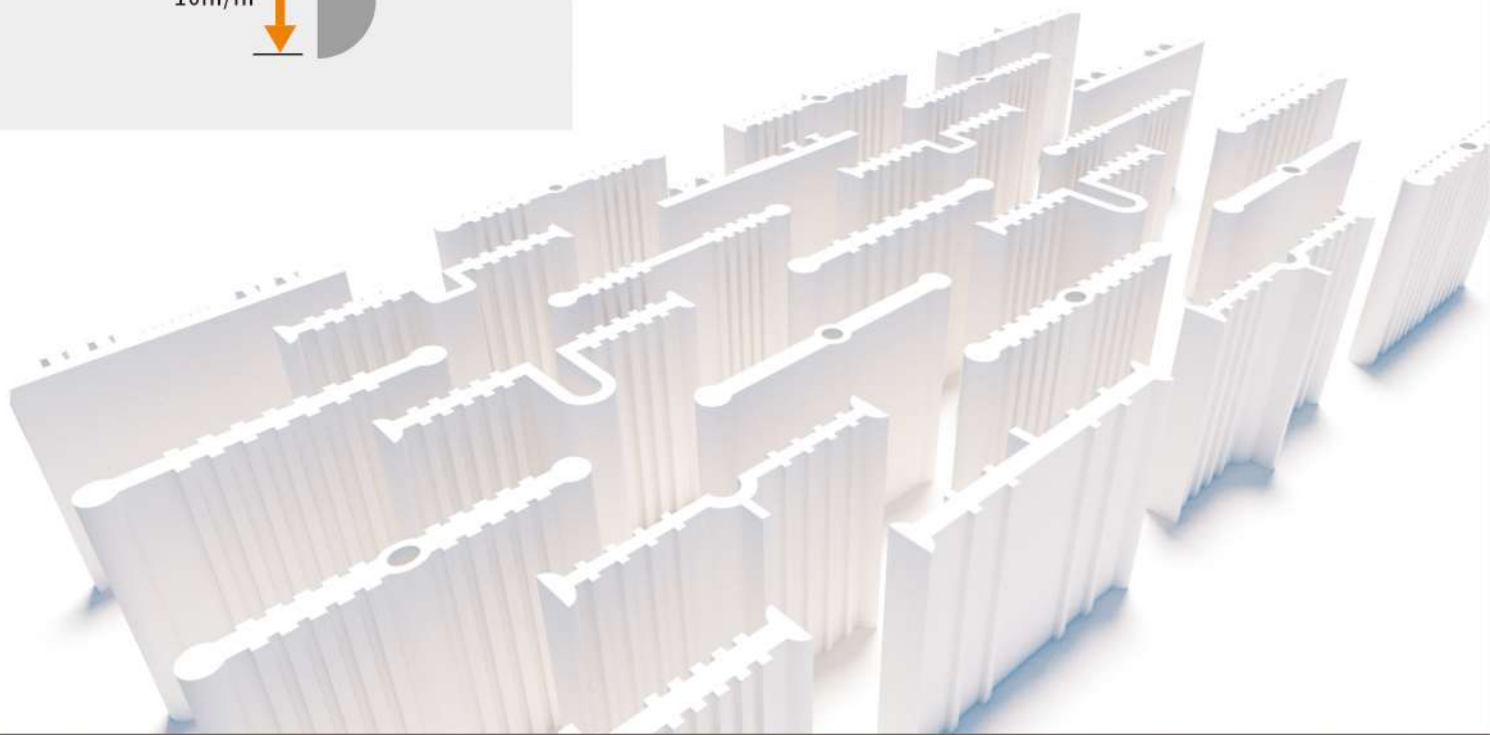

## CNS STANDARD

Item		Unit	Testing method	CNS Standard	
Specific Gravity		-	CNS 3896	1.40 or less	
Direct tensile strength		kgf/cm <sup>2</sup>	CNS 3896	120 or over	
Direct elongation ratio		%	CNS 3896	250 or over	
Hardness (Shore A)		-	CNS 3896	70 or over	
Shear Strength		kgf/cm <sup>2</sup>	CNS 3896	100 or over	
Ageing test	Tensile Strength maintenance	%	CNS 3896	90 or over	
	Elongation maintenance	%	CNS 3896	90 or over	
	Weight maintenance	%	CNS 3896	within ± 10	
Chemical Resistance	Salt Alkali	Tensile Strength variation	%	CNS 3896	within ± 20
		Elongation variation	%	CNS 3896	within ± 20
		Weight maintenance	%	CNS 3896	within ± 5
	Liquid water	Tensile Strength variation	%	CNS 3896	within ± 10
		Elongation variation	%	CNS 3896	within ± 10
		Weight maintenance	%	CNS 3896	within ± 2

Note: For shear strength test, the test piece is obtained by pressing the finished product (thickness about 2mm)

## ASTM TEST

Item		Unit	Testing method	CNS Standard
Material Properties	Specific Gravity	-	ASTMD792	1.35 or over
	Tensile strength	Psi	ASTMD412	2000 or over
	Elongation ratio	%	ASTMD412	300 or over
	Hardness (Shore A)	-	ASTMD2240	75±5
	Shear Strength	Psi	ASTMD732	1400 or over
	Test on weatherability	°C%	ASTMD746	20°C% or less
	Ageing test	Tensile Strength maintenance	%	ASTMD412
Elongation maintenance		%	ASTMD412	90 or over
Material Properties	Tensile Strength variation	%	ASTMD412	1700 or over
	Elongation variation	%	ASTMD412	250 or over

Note: The welding strength should be 80% of original specification when the construction of the water stop joint in normal situation.



**Singform Enterprise Co., Ltd.**



No. 21, Machouhouyuanqu 2nd Rd.,  
Lucao Township, Chiayi County  
611001, Taiwan (R.O.C.)

TEL : +886-5-379-7622  
FAX : +886-5-370-0405  
MAIL : [singform@sf68.com.tw](mailto:singform@sf68.com.tw)